

- |     |   |    |  |
|-----|---|----|--|
| A-I | PARKING LOT (376 TOTAL SPACES)  | 12 | PLAYGROUND   |
| 1   | CONCESSION / RESTROOM   | 13 | WOODED TRAILS  |
| 2   | RESTROOMS  | 14 | FOOT BRIDGE     |
| 3   | PARK ENTRY MONUMENT   | 15 | PICNIC AREA  |
| 4   | MAIN WALK WITH PLANTED SHADE ARBOR  | 16 | GATHERING SPACE  |
| 5   | EXERCISE AREA   | 17 | SEASONAL CREEK  |
| 6   | SOCCER  | 18 | SHADE SHELTER   |
| 7   | BASEBALL (LITTLE LEAGUE) / SOFTBALL (BABE RUTH)   | 19 | AMPHITHEATER   |
| 8   | TENNIS - WITH LIGHTS  | 20 | COMMUNITY PROGRAM SPACE  |
| 9   | PICKLEBALL - WITH LIGHTS  | 21 | YOUTH SPORTS COURT   |
| 10  | BASKETBALL - WITH LIGHTS  | 22 | CREEK ACCESS - WOOD PLATFORM   |
| 11  | SKATE PARK (4,000 SF)   | 23 | EXISTING UTILITY TANKS   |

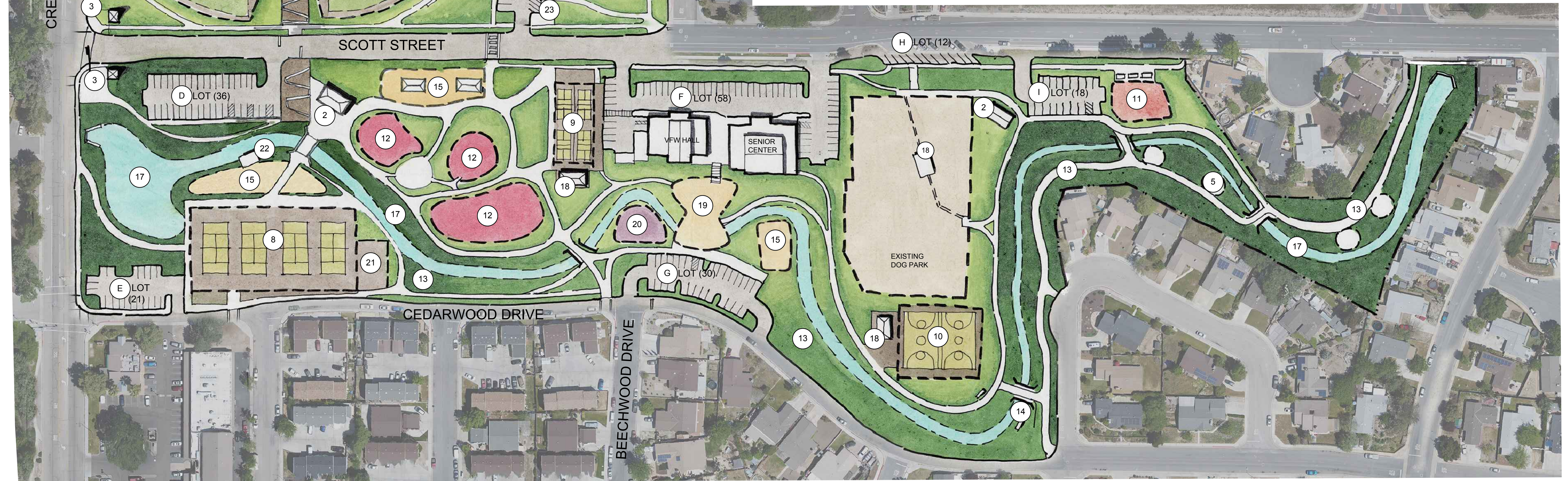

## OPTION 2

### SHERWOOD PARK AREA MASTER PLAN

290 SCOTT STREET  
PASO ROBLES, CA